

LOC		DIST		REVISIONS			
P	LTR	DESCRIPTION	DATE	DN	APVD		
B1		REVISED PER ECO-11-005033	29MAR11	RK	HMR		

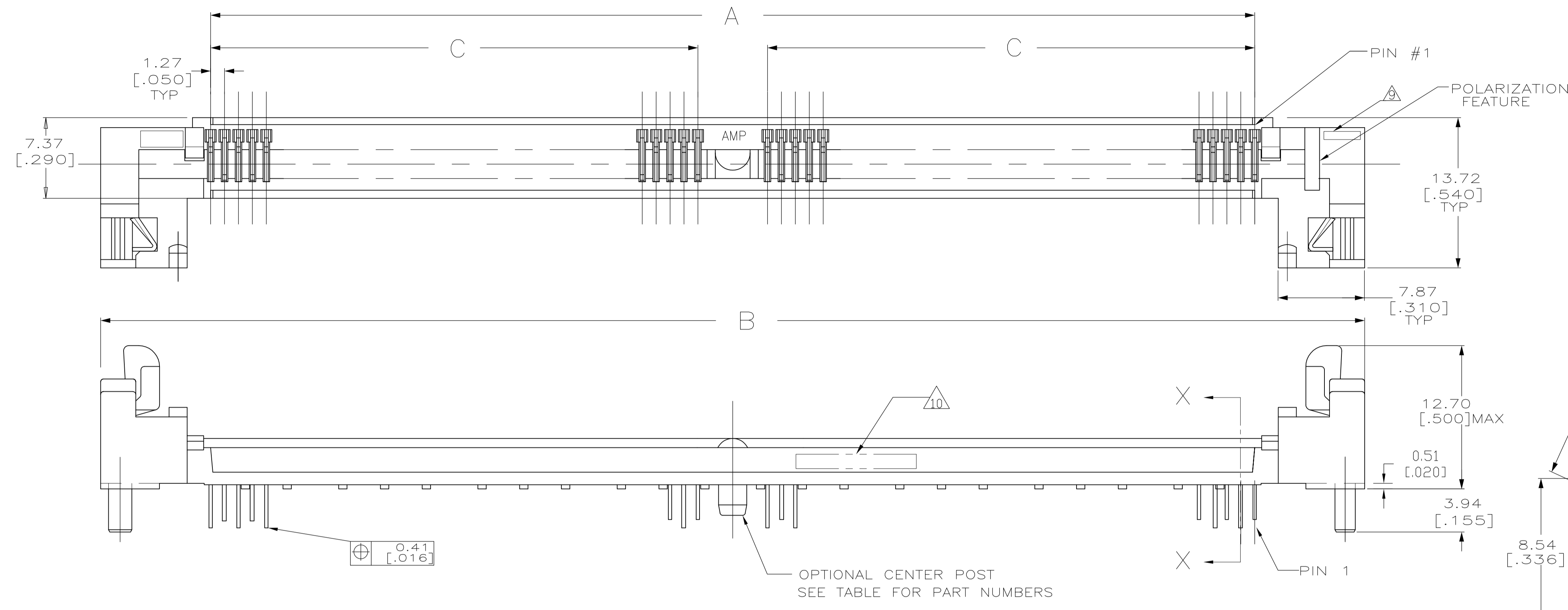

- △ HOUSING-MATERIAL : LIQUID-CRYSTAL-POLYMER.
- △ CONTACT-MATERIAL : PHOS. BRONZE.
- △ LATCH-MATERIAL : STAINLESS STEEL.
- △ CONTACT-PLATE 0.00127 [0.000050] MIN NICKEL ALL OVER.
- △ CONTACT-PLATE 0.00076[0.000030] MIN. GOLD AT CONTACT PTS.
- △ CONTACT SOLDERTAILS-PLATE 0.00508[0.000200] MIN MATTE TIN.
- 7. IN ADDITION TO THOSE RECOMMENDED "SMM" P.C. BOARD DIMENSIONS AND TOLERANCES SHOWN, ALL JEDEC SPECIFICATIONS APPLY AS SHOWN ON MO-116, ISSUE A.
- 8. RECOMMENDED MATING S.I.M.M. TAB METALLURGY:
BASE METAL-COPPER. PLATING TO BE 0.00076[0.000030] MIN GOLD OVER 0.00127[0.000050] MIN NICKEL.
- △ 'S' IDENTIFIER LOCATED APPROXIMATELY AS SHOWN.
- △ DATE CODE INFORMATION (YEAR WEEK), LOCATED APPROXIMATELY AS SHOWN ON OPPOSITE SIDE ONLY.

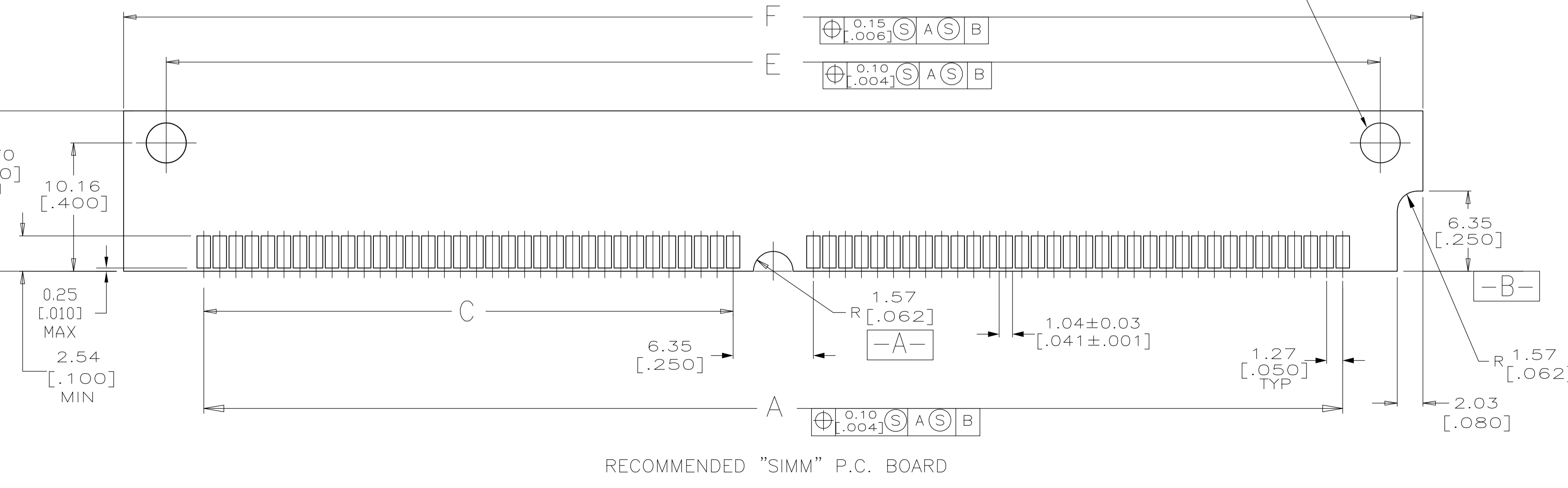
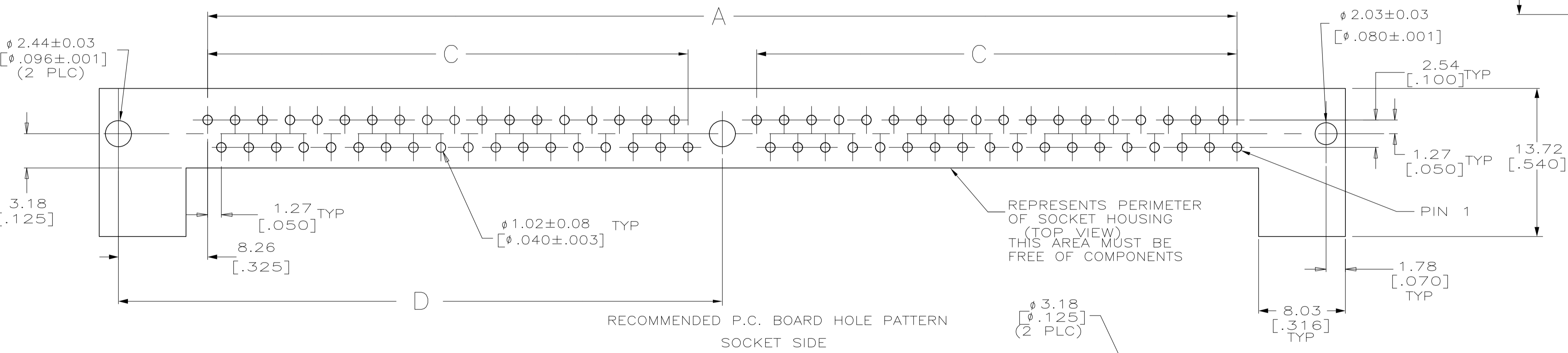
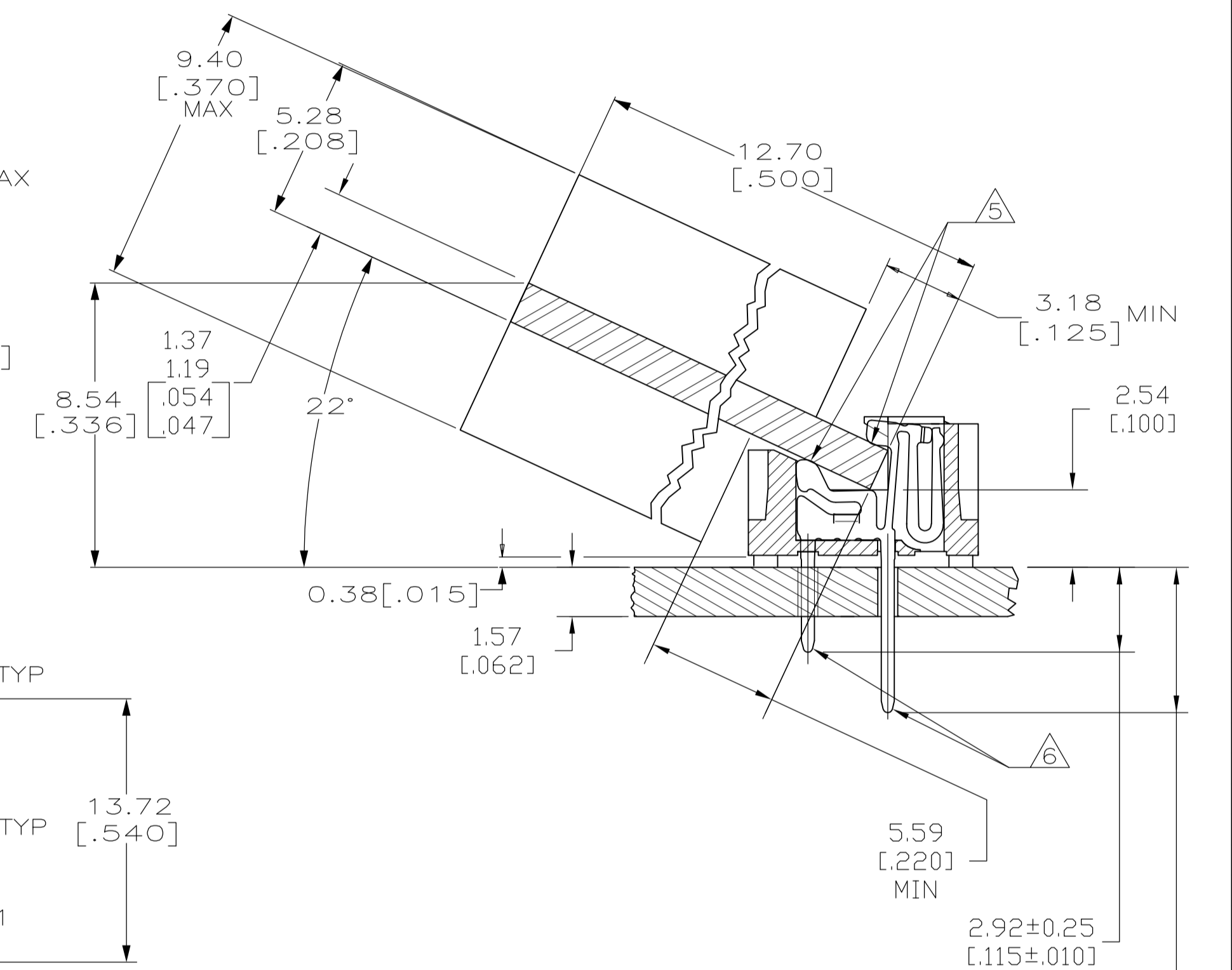

WITH CENTER POST	F	E	D	C	B	A	NO. OF POS	PART NO
	107.95 [4.250]	101.19 [3.984]	55.88 [2.200]	44.45 [1.750]	115.32 [4.540]	95.25 [3.750]	72	5822097-3

THIS DRAWING IS A CONTROLLED DOCUMENT.		DIN B MCMMASTER 06JAN04		STE TE Connectivity	
DIMENSIONS: mm [INCHES]		TOLERANCES UNLESS OTHERWISE SPECIFIED:		NAME	
0 PLC ± -		0.15 [0.006] (A) 0.10 [0.004] (B)		CONNECTOR, MICRO-EDGE, .050, LP, GOLD PL, W/METAL LATCH	
1 PLC ± -		1.04±0.03 [0.041±0.001]		APPLICATION SPEC	
2 PLC ± -		1.27 [0.050] TYP		SIZE	
3 PLC ± 0.13 [0.005]		R 1.57 [0.062]		CASE CODE	
4 PLC ± -		2.03 [0.080]		DRAWING NO	
ANGLES ± -		6.35 [0.250]		A1 00779C=5822097	
MATERIAL		FINISH		WEIGHT	
1 2 3		3 4 5 6		CUSTOMER DRAWING	
SCALE 4:1		SHEET 1 OF 1		REV B1	